

Cassette Sprocket CS-HG50-8 8-Speed S/T/U/V/W-Group

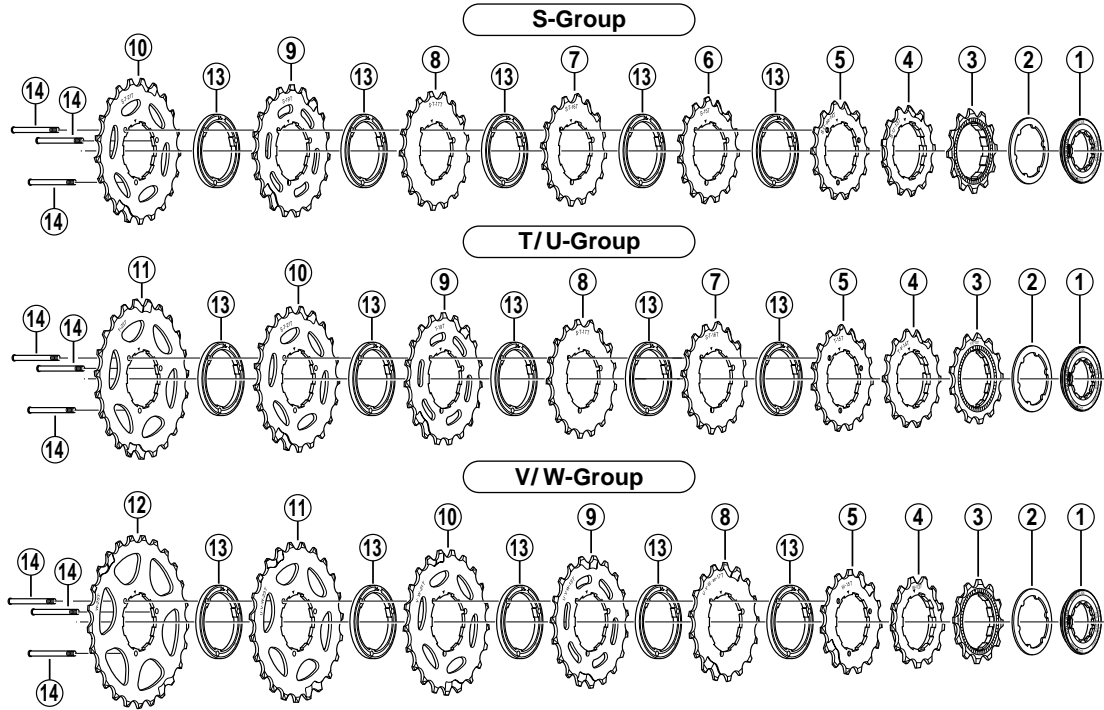

- S-group sprocket teeth combination: 12-13-14-15-16-17-19-21T
- T-group sprocket teeth combination: 13-14-15-16-17-19-21-23T
- U-group sprocket teeth combination: 12-13-14-15-17-19-21-23T
- V-group sprocket teeth combination: 13-14-15-17-19-21-23-26T
- W-group sprocket teeth combination: 12-13-15-17-19-21-23-25T

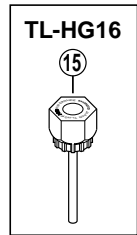

CS-HG70-8

ITEM NO.	SHIMANO CODE NO.	DESCRIPTION	INTERCHANGEABILITY
1	Y-11F 01000	Lock Ring	B
2	Y-11W 02000	Lock Ring Spacer	A
3	Y-11F 1219E	Sprocket Wheel 12T (Built in spacer type) for S/U-Group	B
	Y-11F 1223E	Sprocket Wheel 12T (Built in spacer type) for W-Group	B
4	Y-11F 1320E	Sprocket Wheel 13T (Built in spacer type) for T/V-Group	B
	Y-11F 1319E	Sprocket Wheel 13T (Built in spacer type) for S/U-Group	B
	Y-11F 1323E	Sprocket Wheel 13T (Built in spacer type) for W-Group	B
	Y-11F 1420E	Sprocket Wheel 14T (Built in spacer type) for T/V-Group	B
5	Y-11F 1419E	Sprocket Wheel 14T for S/U-Group	B
	Y-11F 1520E	Sprocket Wheel 15T for T-Group	B
	Y-11F 1522E	Sprocket Wheel 15T for V-Group	B
	Y-11F 1523E	Sprocket Wheel 15T for W-Group	B
6	Y-11F 1519E	Sprocket Wheel 15T for S-Group	B
	Y-11F 1521E	Sprocket Wheel 15T for U-Group	B
7	Y-11F 1619E	Sprocket Wheel 16T for S/T-Group	B
	Y-11F 1719E	Sprocket Wheel 17T for S/T-Group	B
8	Y-11F 1721E	Sprocket Wheel 17T for U/V/W-Group	B
	Y-11F 1919E	Sprocket Wheel 19T for S-Group	B
9	Y-11F 1920E	Sprocket Wheel 19T for T-Group	B
	Y-11F 1921E	Sprocket Wheel 19T for U/V/W-Group	B
	Y-11F 2119E	Sprocket Wheel 21T for S/T-Group	B
10	Y-11F 2121E	Sprocket Wheel 21T for U-Group	B
	Y-11F 2122E	Sprocket Wheel 21T for V/W-Group	B
	Y-11F 2320F	Sprocket Wheel 23T for T-Group	B
11	Y-11F 2321F	Sprocket Wheel 23T for U/V/W-Group	B
	Y-11F 2523F	Sprocket Wheel 25T for W-Group	B
12	Y-11F 2622F	Sprocket Wheel 26T for V-Group	B
13	Y-357 62303	Sprocket Spacer (t = 3.0 mm)	A
14	Y-11W 03000	Sprocket Fixing Bolt (M3 x 26 mm)	A
15	Y-120 09190	Lock Ring Removal Tool (TL-HG16)	A

The table indicates the adaptability of conventional parts to CS-HG50-8 (S/T/U/V/W).

9906-1858

A : Same parts.

B : Parts are usable, but differ in materials, appearance, finish, size, etc.

Absence of mark indicates non-interchangeability.

Specifications are subject to change without notice.

SHIMANO