

S E R I E S

AERNOS XT
Oceania

SHIMANO

SHIMANO AMERICAN CORPORATION
One Holland Drive, Irvine, CA 92618 Tel:(877)577-0600

SHIMANO EUROPE FISHING HOLDING BV
Industrieweg 24, 8071 CT Nunspeet, Holland Tel:(+31)-(0)341-272222

SHIMANO (EUROPA) GMBH GERMAN OFFICE
Diessemer Bruch 114 F, 47805 Krefeld, Germany Tel:(+49)-(0)2151-5567-0

SHIMANO U.K. LTD.
Unit 1A, Vale Park Business Centre, Evesham,
Worcestershire, WR11 6GN United Kingdom, Tel:(+44)-(0)1386425820

SHIMANO ITALY FISHING S.R.L.
Via Privata Maestri del Lavoro 29, 20025 Legnano Milano Italy Tel:(+39)331742711

SHIMANO CANADA LTD./LTEE.
685 The Queensway Peterborough, Ontario K9J 7J6 Tel:(705)745-3232

DUNPHY SPORTS/FISHING IMPORTS PTY LTD.
(SHIMANO AUSTRALIA)
UNIT 1, 1-3 ENDEAVOUR ROAD CARINGBAH N.S.W. 2229 AUSTRALIA Tel:(02)9526-2144

SHIMANO (SINGAPORE) PTE.. LTD.
20 Benoi Sector, Jurong Town, Singapore 629852 Tel:65-2654777

SHIMANO INC.
3-77 Oimatsucho, Sakai, Osaka, Japan Tel:(072)223-3467

Printed in Malaysia 03 (021002)

MAINTENANCE

Your Shimano reel is designed to provide years of dependable performance when properly maintained and lubricated. Exercise care when lubricating. Excess grease and oil can flow into places where it might hinder the performance of the reel. A light coat of grease or a few drops of oil is all that is required.

To clean periodically, spray a towel or rag with a water displacing lubricant or synthetic protectant. Then wipe off dirt, sand and moisture. This light coating will serve as a protectant during storage and will make future cleaning easier. Do not spray the lubricant directly on the reel as it can break down greases and oil within the reel, leading to premature corrosion and decreased drag performance.

We recommend that your reel be professionally cleaned and lubricated at least once a year by a Shimano approved service center in your area.

ORDERING PARTS

When ordering replacement parts, always give the model number, part number and description. Mail this to your nearest Shimano Service Center.

REPAIR

We highly recommend that you refer any servicing and regular maintenance to the Service center in your area where it will be cleaned, lubricated, adjusted, and inspected for signs of wear or damage. When returning a reel for service; Pack the item in a sturdy package with adequate padding for protection. Enclose a note describing the problem, if any, or service needed, include the model number, and include your details so you can be contacted. (for estimate of repair cost of non-warranty items). Mail it insured to your local Service Center.

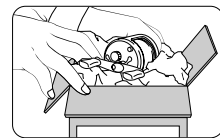

Pack it well.

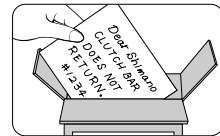

Tell us the problem.

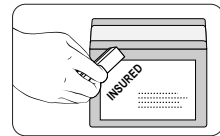

Insure and ship.

FEATURE AND CONTROL POSITIONS

FEATURES:

- 2 stainless steel ball bearings + 1 roller bearing
- 4.4:1 gear ratio (5.2:1 on #2000, 5.1:1 on #3000 & #4000)
- No-play Super Stopper II anti-reverse
- Power Roller
- Front dial drag mechanism with positive click

WARRANTY

Shimano warrants to the original purchaser that this product will be free from non-conformities in material or workmanship for the period of one year from the date of purchase. **Please keep your receipt for all warranty claims.** To request warranty repairs (or non-warranty service) send your reel, postage pre-paid, to the Shimano Service Center nearest you. Retailers and wholesale outlets are not required or authorized to perform warranty repairs or exchanges on behalf of Shimano, nor are they authorized to modify this warranty in any way. In the case of warranty repair requests **(within 1 year of purchase date)**. A dated sales receipt must accompany the warranty claim. Please follow the shipping instructions outlined in the REPAIR section of this document.

Please fill out the enclosed registration card so that we may better meet your needs.

Thank you for purchasing a Shimano fishing reel.

SHIMANO

Shimano's fine fishing tackle carries on a tradition of quality and pride started in 1921 with Shimano's first product, a bicycle freewheel. That same tradition of quality and pride is in every product Shimano manufactures; cold forging, bicycle components, fishing tackle, and the future.

SHIMANO CARES

Literature and packaging included with this product is recycled and recyclable. Please return it to a suitable recycling facility.



To respect the environment
SHIMANO uses recycled paper.
Please do not litter.
This is a recycleable paper product.

CONGRATULATIONS

You have chosen the superb quality and outstanding performance of a Shimano engineered product.

CONTROLS:

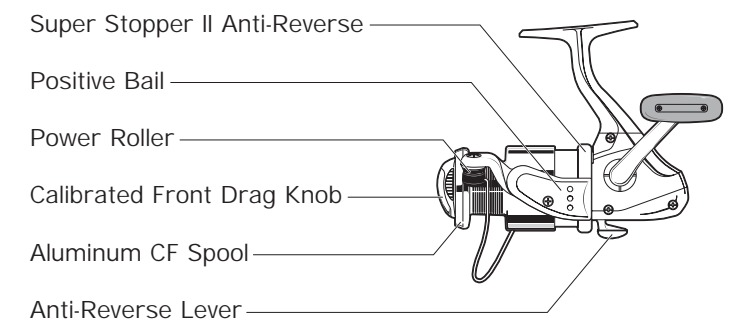

SPECIFICATIONS

OCEANIA AERNOS XT SERIES SPECIFICATIONS:

ITEM No.	GEAR RATIO	WEIGHT oz. (g)	LINE CAPACITY No.-m	lb.-yds.
OCEANIA AERNOS XT 2000	5.2 : 1		2-150, 3-100, 4-70	6-170, 8-120, 10-100
OCEANIA AERNOS XT 3000	5.1 : 1		2-220, 3-150, 4-100	6-230, 8-170, 10-140
OCEANIA AERNOS XT 4000	5.1 : 1		3-200, 4-150, 5-110	8-240, 10-200, 12-160
OCEANIA AERNOS XT 6000	4.4 : 1		4-250, 5-200, 6-150	10-310, 12-240, 14-210
OCEANIA AERNOS XT 8000	4.4 : 1		5-250, 6-200, 8-150	12-320, 14-270, 16-220

EFFICIENT GEARING

The efficiency of 3000, 4000, 6000 & 8000 reels has been improved by 10% to give you smoother and easier retrieves. So, not only is cranking in a hard pulling fish easier, but feeling the movement of your bait or lure is as well because the retrieve is smoother.

COLD FORGED ALUMINUM SPOOL

Aernos XT spinning reels now come with Cold Forged Aluminum Spool for extra strength, rigidity & double anodized to withstand corrosion.



POWER ROLLER

Your new Shimano reel has PowerRoller - a special line roller that reduces spinning reel line twist. PowerRoller reduces the line twist arising from repeated casting and retrieving - up to 50%*.

PowerRoller's special grooved design assures the line will be wrapped on the spool to minimize forward line twist.

*Line twist measured by counting the twists generated by holding the ends of 5 feet of line together along 55 yards of line after 30-90 casts. PowerRoller has no effect on line twist due to the drag releasing, winding against the drag or twirling lures/ bait, etc.

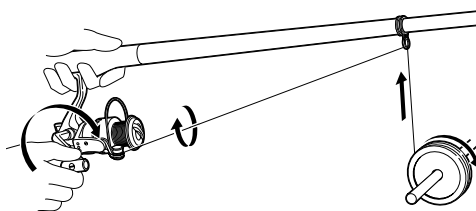

SUPER STOPPER II

This new anti-reverse system has been designed for maximum durability and instant hooksets. The system uses a one-way roller bearing that has been beefed up with extra thick rollers and race.



POSITIVE CLICK BAIL

Now you can be extra sure that the bail is completely open because there is an audible click. An additional spring has also been added to hold the bail open with more authority.

INNER BAIL

Inner Bail is an innovative rotor design that gives you improved line control when casting. Traditional rotor design places the bail wire on the outside of the rotor arms. The Inner Bail system, on the other hand, places the bail wire on the inside of the rotor arms. This change allows us to reduce the distance between the spool and rod (without reducing knuckle clearance), so your index finger can more easily reach and feather the line as it flies off the spool to stop the lure in the spot you want.

REVERSIBLE HANDLE

To accommodate both left and right handed anglers, the handles of all Shimano spinning reels work on either side of the reel. To change from left to right hand drive:

1. Remove the handle screw cap.
2. Place handle on the opposite side.
3. Replace handle screw cap.

FRONT DRAG

To increase drag strength turn the drag knob clockwise, counterclockwise to decrease it. Once completely loose, continue to turn the drag knob counterclockwise to remove the knob and slide off the spool for spool change. When completely tightened by hand the drag is at maximum strength. Forcing the knob to turn further or using tools to turn it may result in damage to the reel.

To change spool, loosen the drag completely, unscrewing the drag adjustment knob completely. Slide the spool off the shaft. When removing and replacing spools ensure that the drag parts are properly fitted on the spool shaft, and that the spool is firmly seated.

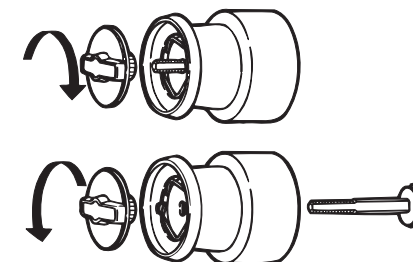

LINE KEEPER CLIP

The line keeper clip on the side of your spool is a handy spot to hold your line so it does not unravel in storage. With the line completely wound on to the spool, simply make a small loop in the end of the line and slide it under the clip. Pull on the free end of the line to take up any slack.

